

QUALITY  
INNOVATION  
CUSTOMER  
FIRST

JINJIANG PHILADELPHIA MACHINERY CO.,LTD

Add: Jinjiang, Quanzhou ,Fujian ,China  
Email:angela@philatex.com  
Whatsapp:+86-18859799633  
Skype:angelaliz520

[www.degloabalconsulting.com](http://www.degloabalconsulting.com)



Circular knitting machine  
& its spareparts

QUALITY  
INNOVATION  
CUSTOMER  
FIRST

DE GLOBAL CONSULTING,  
12,PUSHPA APT. VANAJ CORNER; PUNE-38  
+918780041406, sales@degloabalconsulting.com

## ■ CONTROL PANEL & INVERTER



PTU-01A



PTS-02A



PTX-05A



PTXH-03A



PTXH-04A



PTX-06A



Delta



Inv't



SIMENS



Fuji



Yolico



SA

Circular knitting machine & its spare parts

## ■ HOT AND NEW SPARE PARTS PROMOTION



BLF lycra feeder



SER lycra feeder



CPF yarn feeder



SPF yarn feeder



NPF yarn feeder



APF yarn feeder



BY-12S Quantitative (Pressure) Oil Pump



New type air gun



BYN-6S New Type electric spraying lubricator



BY-16S high effective mist lubricator



BY-F16R high effective mist lubricator



BY-TC6 electric spraying lubricator

■ ZIRCONIA YARN GUIDE



■ ZIRCONIA YARN GUIDE



Circular knitting machine & its spare parts

NEEDLES

品名番号 / NEEDLE NO.	
6422 DB2	
6422 DC2	
6422 CC2	
6422 CB2	
WO 63.41 Y01	
WO 63.41 Y02	
WO 63.45 Y01	
WO 63.45 Y02	
VO 65.36 Y01	
VO 65.41 Y01	
VOTA 65.41 Y004	
VO 65.41 Y007	
VO 122.41 Y01	
VO 122.41 Y02	
VO 122.41 Y03	
VOTA 122.41 Y01 (小取)	
VO 122.41 Y01 (小取)	
VO 122.41 Y02 (小取)	
VO 122.41 Y03 (小取)	

NEEDLES

品名番号 / NEEDLE NO.	
VO 141.52 Y001-7	
VO 141.52 Y002-7	
VO 141.52 Y003-7	
VO 141.52 Y004-7	
VO 141.52 Y005-8	
VO 141.52 Y006-8	
VO 141.52 Y007-8	
VO 141.52 Y008-8	
VO 141.41 Y001-7	
VO 141.41 Y002-7	
VO 141.41 Y003-7	
VO 141.41 Y004-7	
VO 141.41 Y005-8	
VO 141.41 Y006-8	
VO 141.41 Y007-8	
VO 141.41 Y008-8	
VO 104.41 Y0018	
VO 104.41 Y0019	
VO 104.41 Y0020	

Circular knitting machine & its spare parts

**SINKERS**

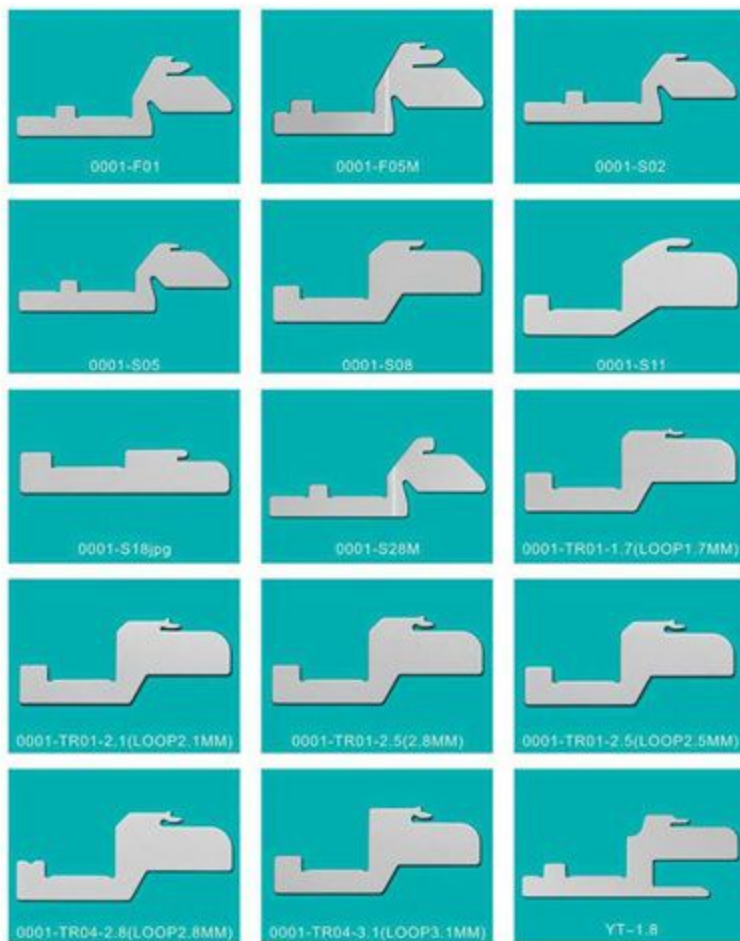

**SINKERS**



Circular knitting machine & its spare parts

## JACKS AND AUXILIARIES



**BELT SERIES:  
TIMING BELT,  
PUNCHED BELT**

**ALL FOR DRIVING**

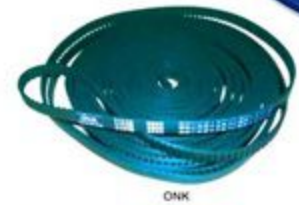
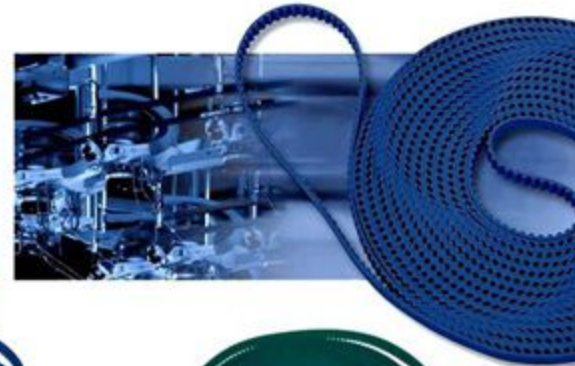

⊙ Ladder Tooth Type Belt XL, L, M, TS, T10  
 ⊙ Circular Arc Type Belt 3M, 5M, 8M



**BY1002A** **BY1002B** **BY1002C** 10MM 9-11MM 12MM 9MM

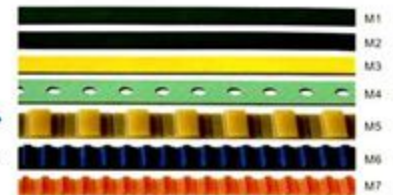

Circular knitting machine & its spare parts

## MEMMINGER-IRO PRODUCTS



MPF P POSITIVE FEEDER



MPF L POSITIVE FEEDER



MER 3 LYCRA FEEDER



EFS 800-Electronic yarn feeder



MJS 2 STRIPER FEEDER



NEO storage feeder



SFE storage feeder



PULSONIC 5.2 OILER



UNIWAVE PROJECTILE LF



UNIWAVE PROJECTILE 419



UNIWAVE PROJECTILE ECO



MNC 2 NEEDLE DETECTOR



LMW 3 FABRIC SCANNER



DECOTEX IP



LMT 7



MLT WESCO

## MEMMINGER-IRO PRODUCTS



MIS sensor



OFW stop motion



UFW stop motion



NW needle detector



COMBI side creel



FAN round creel



FILTERCREEL 3



MRA2 motor belt drive



GAP



Toothed Belts



NAVIGATOR



VCL5 deduster



VCL4 deduster



Toothed Belt Bonding



SK FLUTTER BLOWER



DK FLUTTER BLOWER

## LYCRA WHEEL PULLEY

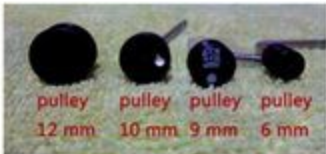

Different types of lycra wheel can be offered.

TYPE of wheel: with bearing, without bearing, ceramic wheel etc.  
 DIA of wheel: 15mm, 12mm, 11mm, 10mm, 9mm, 6mm  
 DIA of steel wire: 2mm, 1.5mm  
 DRAWING OF LYCRA WHEEL FOR REFERENCE:

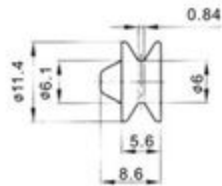

Lycra guide pulley without bearing wire  $\phi 2$

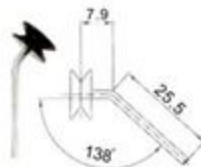

## YARN GUIDE, BRACKET AND YARN GUIDE EAR





## ■ HIGH QUALITY CAM,CAM BOX,YARN GUIDE SUPPLY



Japanese Hitachi Steel materia is used to make cam,cam box and yarn guide

Quality Guarantee.Made according to Sample or Drawing



## ■ SPECIAL SCREWS AND ACCESSORIES



Socket cap screw	A	B	C	D	E	L
MA-85-7P10.7	5.8	3.2	3.5	4.5		9.7
Socket cap screw	A <td>B <td>C <td>D <td>E <td>L</td> </td></td></td></td>	B <td>C <td>D <td>E <td>L</td> </td></td></td>	C <td>D <td>E <td>L</td> </td></td>	D <td>E <td>L</td> </td>	E <td>L</td>	L
MA-PL-7P17.7	4.8	2.5	4.0			17.7
Washers	A <td>B <td>C <td>D <td>E <td>L</td> </td></td></td></td>	B <td>C <td>D <td>E <td>L</td> </td></td></td>	C <td>D <td>E <td>L</td> </td></td>	D <td>E <td>L</td> </td>	E <td>L</td>	L
MA-10	6.0	1.8	2.7			32
MA-20						36
Washers	A <td>B <td>C <td>D <td>E <td>L</td> </td></td></td></td>	B <td>C <td>D <td>E <td>L</td> </td></td></td>	C <td>D <td>E <td>L</td> </td></td>	D <td>E <td>L</td> </td>	E <td>L</td>	L
MA-10	10.8					11.3

Socket cap screw	A	B	C	D	E	L			
MA-8-7P11.1	5.8	3.0	3.2	3.0	2.5	11.8			
MA-8-7P11.1	6.25	3.0	3.0	2.5	6.5	11.8			
MA-8-7P11.1	5.8	3.0	2.8	2.0	6.5	10.0			
MA-8-7P11.1	5.8	3.0	2.8	2.0	6.5	9.0			
MA-8-7P11.1	5.7	3.0	2.8	2.0	7.8	11.0			
Column Cap Cross Scribe	A <td>B <td>C <td>D <td>E <td>L</td> </td></td></td></td>	B <td>C <td>D <td>E <td>L</td> </td></td></td>	C <td>D <td>E <td>L</td> </td></td>	D <td>E <td>L</td> </td>	E <td>L</td>	L			
MA-8-7P17.0	5.8	2.0				7.5			
MA-8-7P18	5.8	2.0				9			
MA-8-7P19	5.8	2.0				10			
MA-8-7P21	5.8	2.0				11			
MA-8-7P22	5.8	2.0				12			
MA-8-7P24	5.8	2.0				14			
Customized Head cap screw	A <td>B <td>C <td>D <td>E <td>L</td> </td></td></td></td>	B <td>C <td>D <td>E <td>L</td> </td></td></td>	C <td>D <td>E <td>L</td> </td></td>	D <td>E <td>L</td> </td>	E <td>L</td>	L			
MA-8-7P21.1	5.8	1.8	1.5	1.5	6.8	11.8			
Column cap screw	A <td>B <td>C <td>D <td>E <td>L</td> </td></td></td></td>	B <td>C <td>D <td>E <td>L</td> </td></td></td>	C <td>D <td>E <td>L</td> </td></td>	D <td>E <td>L</td> </td>	E <td>L</td>	L			
MA-8-7P24	5.8	2.0	2.0			14.0			
MA-8-7P25	5.8	2.0	2.0			15.0			
New Socket Cap Top Screw	A <td>B <td>C <td>D <td>E <td>F <td>G <td>H <td>L</td> </td></td></td></td></td></td></td>	B <td>C <td>D <td>E <td>F <td>G <td>H <td>L</td> </td></td></td></td></td></td>	C <td>D <td>E <td>F <td>G <td>H <td>L</td> </td></td></td></td></td>	D <td>E <td>F <td>G <td>H <td>L</td> </td></td></td></td>	E <td>F <td>G <td>H <td>L</td> </td></td></td>	F <td>G <td>H <td>L</td> </td></td>	G <td>H <td>L</td> </td>	H <td>L</td>	L
MA-85S-7P10.2	6.0	1.8	2.5	1.25	4.25	5.0	1.2	1.6	33
MA-85S-7P10.2	6.0	1.8	2.5	1.25	4.25	5.0	1.2	1.6	33
MA-85S-7P10.2	6.0	1.8	2.5	1.25	4.25	5.0	1.2	1.6	33

Circular knitting machine & its spare parts

## ■ TAPE TENSIONER AND ACCESSORIES



## ■ HIGH QUALITY CAM,CAM BOX,YARN GUIDE SUPPLY

Quality Wheel Inside Dia:  $\varnothing 17$ ,  $\varnothing 18$ ,  $\varnothing 19$ ,  $\varnothing 20$

Quality Wheel Outside Dia:  $\varnothing 210$ ,  $\varnothing 250$ ,  $\varnothing 300$



Double Quality Wheel



Single Quality Wheel

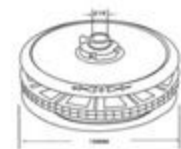

BY1021A48 BY1021A49 BY1021A50



BY101101

BY101102



BY1021A47



BY1021A51



Cylinder of Double Jersey



Plastic Bearing Housing



Cylinder Spring



Cylinder of Single Jersey



Cylinder Cleaner ( 36G-9G )



BY1021A54  
UK Wire Bearing Race

Circular knitting machine & its spare parts

## ■ TEXTILE EQUIPMENT (ELECTRONIC FABRIC SCALE, SAMPLE CUTTER AND FABRIC MAGNIFIER)



DF28A219



DF28A220



BY12A



BY12B (Electronic)



DF28A221



DF28A223

Different Types of Sample Cutter  
Germany or China Taiwan Knives Optional  
Aluminium body, Never Rusty  
Easy to adjust or change knives



Electronic Fabric Scale 100g-200g



Scale



4-Standard Light Cass



USA PANTONE Color Card



Fabric Magnifier with Led light



Density Meter



Fabric Sample Scissors BY12C



BY44M01



BY44M02



BY44M03

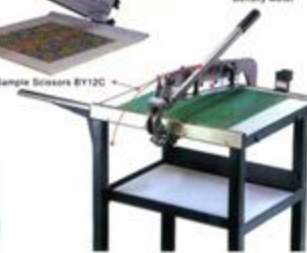

BY44FC3

## TENSION METER, DLAL INDICATOR AND TOOLS



Germany Tension Meter Japan Tension Meter Yarn Length Rate Meter Thickness Meter Hardness Meter Twin Meter with holder



Japan Balance Meter China Made Balance Meter Japan Percentage Meter China made Percentage Meter with ear Single meter with holder Meter Holder without micro adjustment Meter Holder with micro adjustment

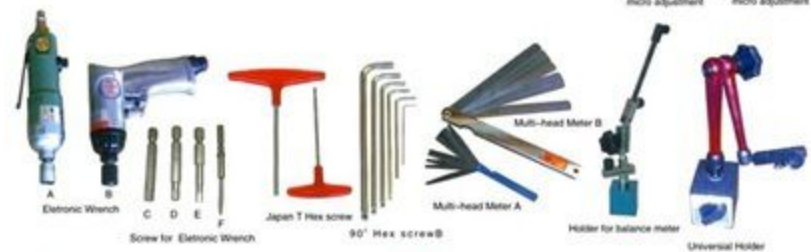

Electronic Wrench A B Screw for Electronic Wrench C D E F Japan T Hex screw 90° Hex screw B Multi-head Meter A Multi-head Meter B Holder for balance meter Universal Holder



Scissors A B Plier C D E F G Ring Type fabric knives BY13A Fabric knives BY13B A1 Scraper, needle holder etc. A B C D E F G H

## Circular knitting machine & its spare parts

## NEEDLE DETECTOR AND WIRE



## NEW TYPE FABRIC TAKE DOWN DEVICE



BYFTD1



BYFTD2



BYFTD3



BYFTD4



BYFTD5



BYFTD6

Circular knitting machine & its spare parts

## ACCESSORIES OF TAKE DOWN DEVICE



LEFT

RIGHT



Active Drive Arm



Clock wise installation Anticlock wise installation

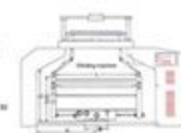
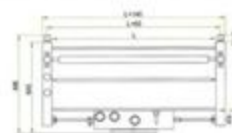
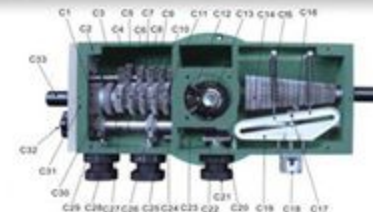

BY48S-FS



Size Specification Of Machine

Specification Length L(mm)	650	750	850	950	1050	1150	1250	1350	1450	1550	1650	1750
Tactical diameter ΦA	900	1000	1050	1100	1150	1200	1250	1300	1350	1400	1450	1500



BY48R-FS

## Circular knitting machine & its spare parts

### ■ TAKE DOWN DEVICE

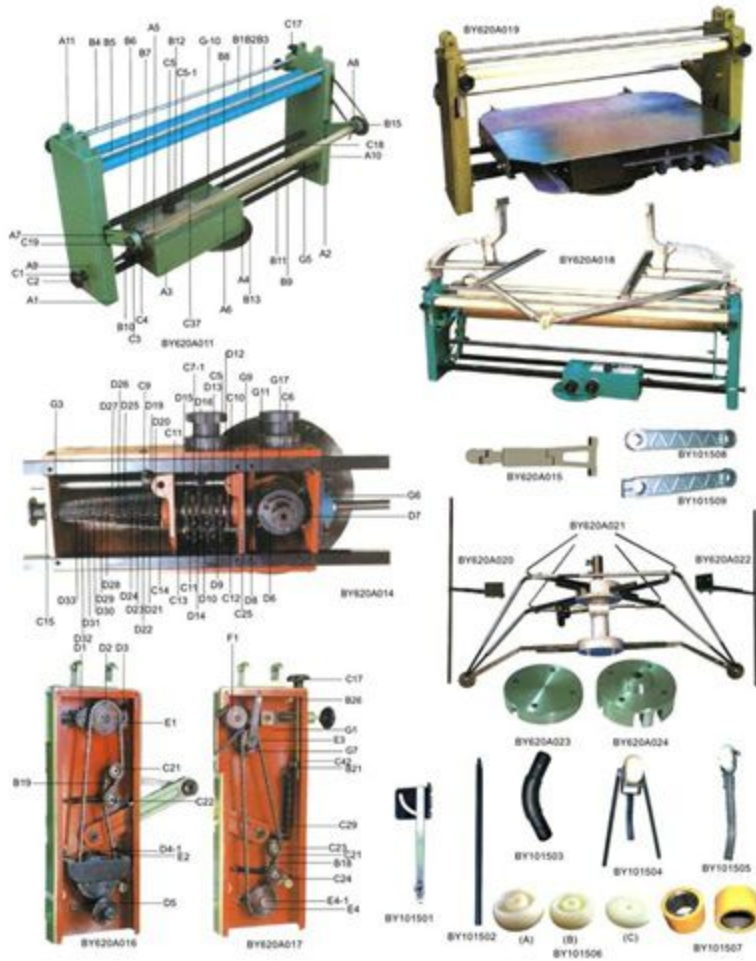

### ■ ACCESSORIES OF TAKE DOWN DEVICE



■ **YARN FEEDER AND POSTIVE FEEDER SERIES**



■ **YARN FEEDER AND POSTIVE FEEDER SERIES**



## ■ YARN FEEDER AND POSTIVE FEEDER SERIES



## ■ YARN FEEDER AND POSTIVE FEEDER SERIES



## STOP MOTION AND ALARMLIGHT



## Circular knitting machine & its spare parts

## ELECTRIC





Circular knitting machine & its spare parts

■ YARN FEEDER AND LYCRA FEEDER



■ STRIPPER FEEDER RUBBER



■ YARN FEEDER ACCESSORIES



## TAIWAN SHENGSONG DEDUSTER AND LUBRICATOR



Circular knitting machine & its spare parts

## SHENGGUANG DEDUSTER AND LUBRICATOR



## TAIGUAN SPRAYING LUBRICATOR AND BLOWER



## ■ OILER AND LUBRICATOR



BYN-6S ELECTRIC OILER

BY-12S QUANTITATIVE OILER

TC-6 lubricator



CKMTC6blower

ssi160

LK-E6

wheel3002



BY-12s parts



TC-6parts



BY-F10 blower

Circular knitting machine & its spare parts

## ■ ACCESSORIES OF LUBRICATOR AND BLOWER



BY610A44 Hose or Oil Pipe



## ■ ACCESSORIES OF LUBRICATOR AND BLOWER



Circular knitting machine & its spare parts

## ■ HIGH QUALITY KNITTING OIL



## ■ CLEANSER, RUST-BAN AND MARKING PEN



## ■ YARN CARRIER ACCESSORIES



Circular knitting machine & its spare parts

## ■ CERAMIC PARTS

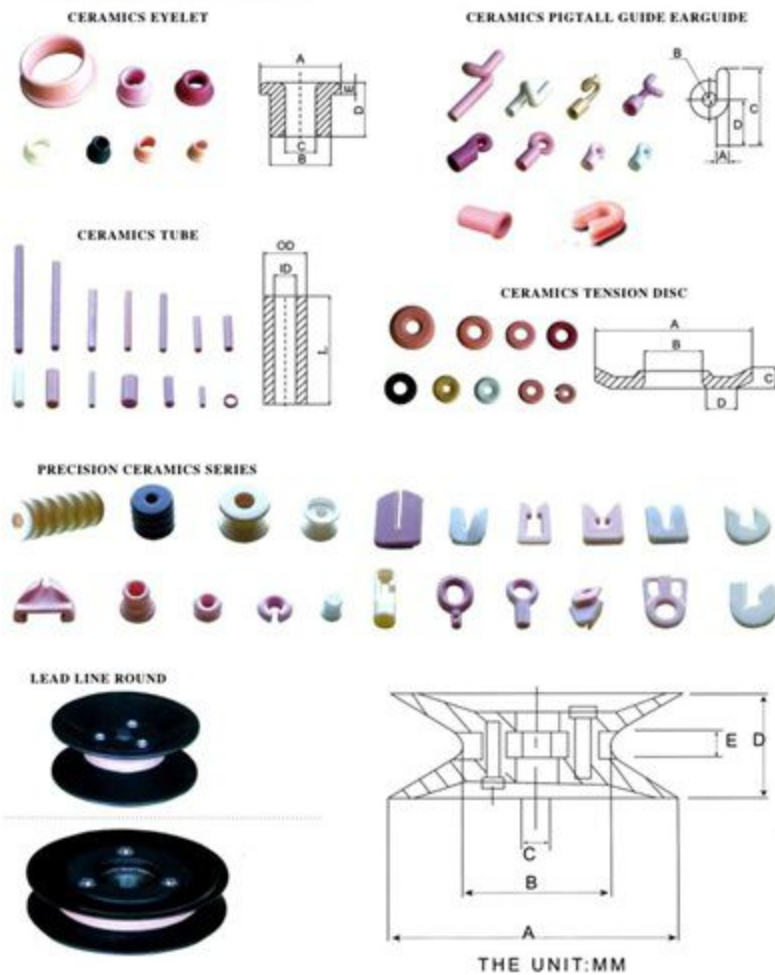

## ACCESSORIES OF FLAT KNITTING MACHINE



Circular knitting machine & its spare parts

## NEW PRODUCTS



## AIR JET TUBE CREEL STAND



## Circular knitting machine & its spare parts

### CREEL STAND

